

# ALTA ROBBINS



- For liquid and gaseous applications requiring leakproof sealing in operation from vacuum to 6000 psi
- Stem threads sealed out of fluid flow for less wear and longer life
- Low operating and shutoff torque
- Fine metering control
- Low pressure drop
- 4-to-1 safety factor
- Simple to service - all functional parts can be removed for cleaning or replacement without disturbing body connections using standard tools
- Unique seat containment - Replaceable, large soft seat is fully contained in bonnet which provides fine metering control, zero leakage, and long service life
- Panel mounted in seconds without exposing functional parts

## FLOW PATTERN



3 WAY

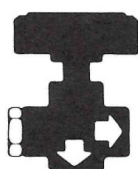

ANGLE



LINE

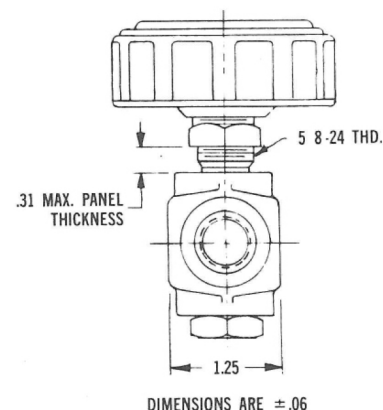
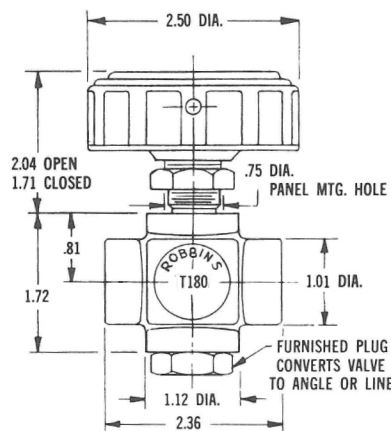

## TECHNICAL DATA

**MAX OPERATING PRESSURE:** 6,000 PSI\*

**SAFETY FACTOR:** 4:1

**CV:** Angle=0.40; Globe=0.33

**INTERNAL & EXTERNAL LEAKAGE:** Zero

**ORIFICE DIAMETER:** 0.180 Inch

**BODY MATERIAL:** 303 SS (Passivated)

**O-RING MATERIAL:** Buna-N (Standard)

**SEAT MATERIAL:** See Ordering Information

**OPERATING TEMPERATURE:** -40°F to +250°F

**PORTS:** 3/8" Female Tube (AS5202)\*\*

**WEIGHT (APPROXIMATE):** 1.06 lb

**HANDLE TURNS TO OPEN:** 7 (Approximate)

\*\* Interchangeable with SAE, AND 10050-6, and MS33649-6

## ORDERING INFORMATION

MODEL NUMBER	SEAT MATERIAL	PORT CONNECTION	PSI MAX
T180	Kel-F	AS5202**	6000
NT180	Nylon	AS5202**	6000
TT180	Teflon	AS5202**	1000*

\* Use of Teflon Seat with Metal Insert permits operation to maximum rated pressure of 6000 PSI. To order, see below

### FOLLOWING SUBSTITUTE O-RINGS AND SEATS ARE AVAILABLE

add to Model No.

#### O-RINGS

Kalrez .....-08  
 Butyl (Not recommended for over 1000 PSI) .....-91  
 Viton (Not recommended for over 1000 PSI) .....-12

**SEATS with METAL INSERTS.** .....-763

## MAINTENANCE

Valve can be serviced without removal from line using standard tools.

**IMPORTANT:** Lubricate Stem threads and Stem O-Rings regularly with Halocarbon 25-5S or equal.

### REPLACEMENT OF SEAT AND/OR O-RING SEALS

1. Open valve fully. Loosen Handle Set Screw and remove Handle and Locknut.
2. Unscrew Bonnet and remove Bonnet O-Ring.
3. Using Handle as a wrench, screw Stem out of Bonnet clockwise, thereby ejecting Seat and Stem. Remove Stem O-Ring.
4. Clean all parts well with solvent. Lubricate lightly Stem threads and all O-Rings. Install Bonnet and Stem O-Rings.
5. Screw Stem into Bonnet until engaged with Bonnet threads; use Handle to retract Stem to full limit.
6. Replace Seat in Bonnet cavity, chamfered end first, making sure it is well seated.
7. Replace Bonnet Assembly in Body, torquing to 65 inch pounds for TEFLON Seats, and 125 inch pounds for KEL-F Seats, and 200 inch pounds for NYLON, and all Metal Insert type Seats.
8. Replace Locknut torquing to 100 inch pounds. Replace Handle; tighten Set Screw firmly.

Manufactured in accordance with ASME B31.3

## REPLACEMENT PARTS

NAME	PART #
B <b>Bonnet</b>	27
C <b>Stem</b>	26
D <b>Seat, Kel-F</b>	8-41
- <b>Seat, Nylon</b>	8-21
- <b>Seat, Teflon</b>	8-11
K <b>Seat, Kel-F with Metal Insert</b>	A8-41
- <b>Seat, Nylon with Metal Insert</b>	A8-21
- <b>Seat, Teflon with Metal Insert</b>	A8-11
E <b>O-Ring, Stem- Standard- 2 required</b> Buna-N, 90 durometer, ARP Size 568-008	5008-56
<b>O-Ring, Stem- Alternate- 2 required</b> Buna-N, 70 durometer, ARP Size 568-008	5008-51
F <b>O-Ring, Bonnet</b> Buna-N, 70 durometer, ARP Size 568-113	5113-51
G <b>Locknut</b>	6AB
H <b>Handle with Set Screw</b> Set Screw (=10-24x 3/8 Long Half Dog Point)	A28-1 10386-4
J <b>Sealing Plug</b> (AN814-6C or equal) w/O-ring O-Ring, Buna-N, ARP Size 568-906	A56-6 6006-55
- <b>Washer</b> (Not shown — Not supplied with assembled valve except by request)	5AB
- <b>O-Ring Installation Mandrel</b>	T-221-3

---

- <b>Bonnet Assembly</b> (F,B,C,E(2),D OR K)	
- with Kel-F Seat	KA53
- with Nylon Seat	NA53
- with Teflon Seat	TA53

For Metal Insert, add -763 to Bonnet Assembly part number

Consists of all functional parts, sealed and ready to install in body

- <b>Soft Goods Kit</b> (F, E (2), D)	
- Kel-F	4003-4-1
- Nylon	4003-2-1
- Teflon	4003-1-1

For Metal Insert, add -763 to Soft Goods Kit part number

*See Ordering Information section for optional o-ring part numbers*

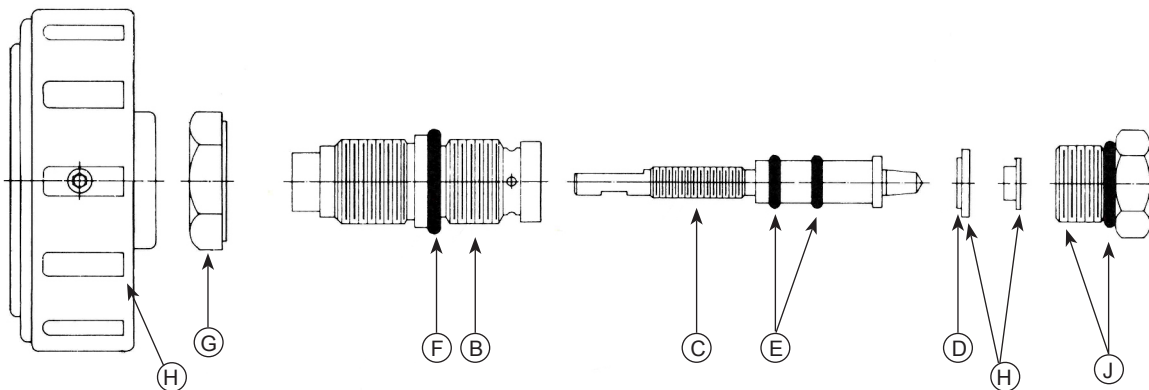

110 SOUTH 1200 WEST, LINDON UTAH 84042 · PHONE (801) 785-1114 · FAX (801) 785-4333 · WEB ALTAROBINS.COM

**WARRANTY:** ALTA ROBINS WARRANTS TO THE PURCHASER OF ITS PRODUCTS THAT ANY PART THEREOF WHICH PROVES TO BE DEFECTIVE IN MATERIAL OR WORKMANSHIP WITHIN ONE YEAR FROM THE DATE OF ORIGINAL PURCHASE FOR USE WILL BE REPLACED FREE OF CHARGE. THIS WARRANTY DOES NOT APPLY TO DAMAGES RESULTING FROM ACCIDENTS, ALTERATIONS, MISUSE, OR ABUSE.

**NOTICE:** THE DESIGNS, DATA, AND/OR PROCESSES SET FORTH HEREIN OR IN CONNECTION HERewith ARE DIRECTLY RELATED TO PRODUCTS OF ALTA ROBINS.